

# UNDERWATER BICYCLE

## TECHNICAL SPECIFICATIONS



EWAC

**MEDICAL**

*We get you moving*



## Product Description

The Aquabike is specially designed for the use in rehabilitation centres. The frame is made from polished stainless steel AISI 316 and therefore suitable for use in swimming pools. At the front 2 wheels are mounted for easy relocation and moving of the bicycle within the pool. The cranks are equipped with 2 pedals including fixation strap. The resistance is achieved with a turbine. The saddle is height adjustable. The Aquabike may only be used in water and not outside.

## Function

To perform stationary cycling exercises in a fixed location of the pool for rehabilitation or training purposes. It is equipped with a unique resistance mechanism, which causes resistance to increase exponentially with the cycling speed. The unique resistance mechanism closely resembles the conditions actual cycling. Increasing speed takes a considerable effort. Slowing down, the inertia gives the sensation the bike is still going. The resistance increases exponentially with velocity. Both the saddle and the safety straps at the paddles can be adjusted as per the user's needs.

## Options

Not applicable.

## Product Characteristics

1. Hand support
2. Saddle
3. Turbine
4. Pedal
5. Wheel

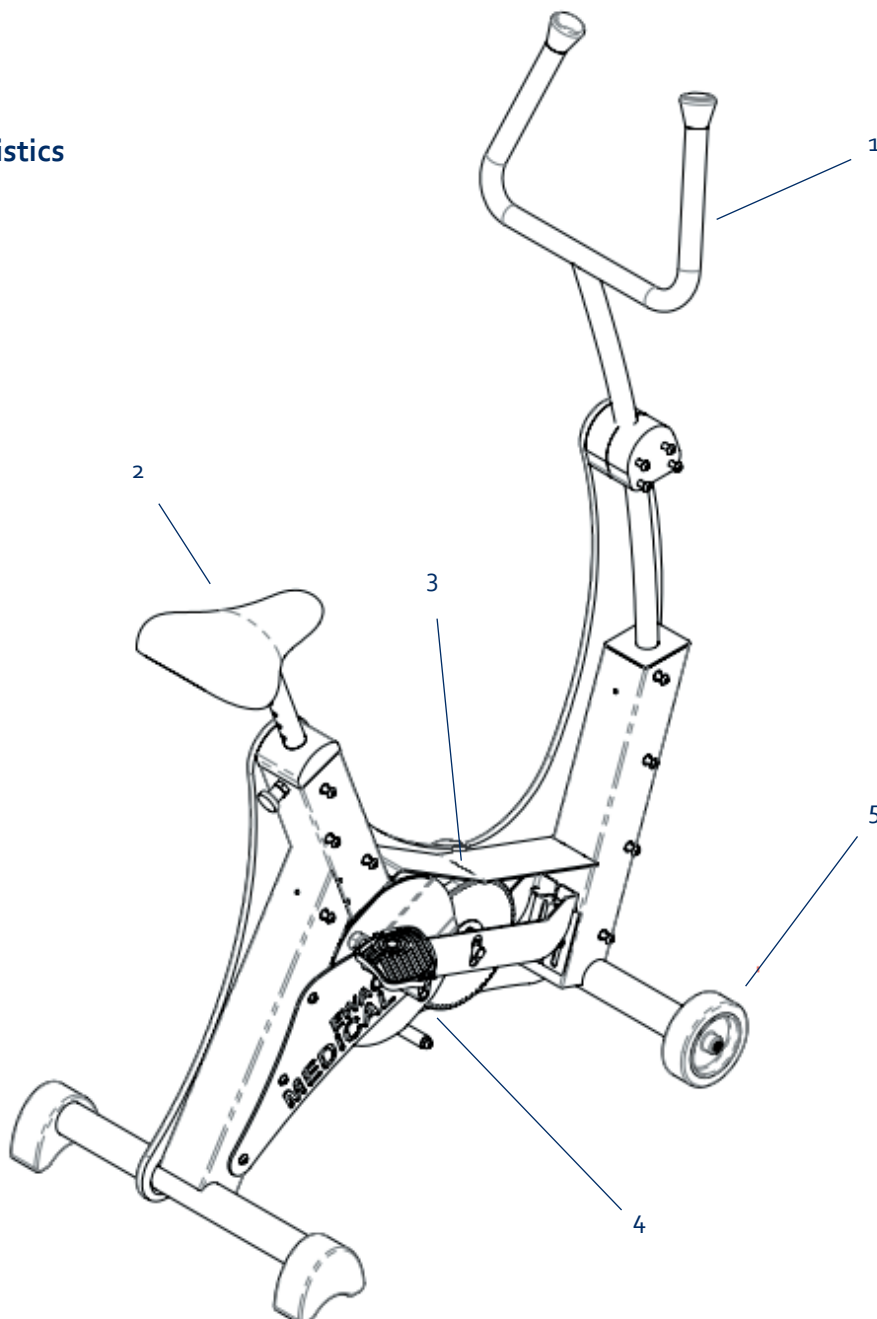

## Technical Information

Total height front side: 1500 mm  
 Total height saddle: from 785 up to 950 mm  
 Width: 550 mm  
 Length: 1000 mm  
 Weight: 35 kg

## Packing information

Material: Wooden box  
 Width: 850 mm  
 Length: 850 mm  
 Height: 165 mm  
 Weight: 70 kg



EWAC Medical is certified according to:

ISO 9001:2015

ISO 13485:2012

by Lloyd's Register Nederland



EWAC Medical  
 Galileistraat 20  
 1704 SE Heerhugowaard  
 The Netherlands

**EWAC**  
**MEDICAL**  
*We get you moving*

Subject to change without notice

+31 226 313 457  
 medical@ewac.nl  
 www.ewacmedical.com